



WALL FLUSH SKIRTING BOARD

for design-lovers



THE INNOVATIVE BUILDING TECHNIQUE FOR SUPERIOR STANDARDS

Functional fitting due to a unique plug system

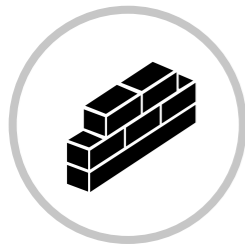

The flush skirting meets simple, timeless elegance with comfort and modern well-being in your own home. Suitable for solid and dry construction.

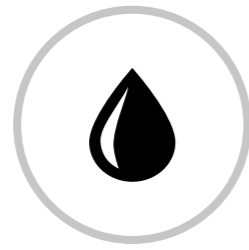

Annoying dusting of the skirting board upper edge and thus also the resulting wiping marks on the walls belong to the past.



Since there is no direct contact between floor, skirting and brickwork, there will be no floor vibrations transmitted.

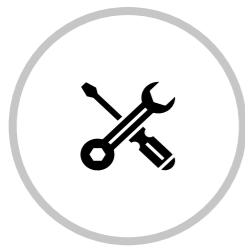

Quick and easy assembly through the patented plug-system with corresponding corner and linear connectors. This eliminates the need for time-consuming mitre cut.



The skirting profile is applied directly to the raw brickwork before the plasterwork. The top edge conduces as a guideline for the vertical and horizontal arbor. That simplifies the plasterwork and saves valuable time when setting the edges.

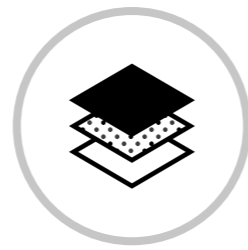

New standards in material selection: from the classic wooden types up to aluminium and stainless steel, dirt-repellent surfaces, Corian, Carbon and many more.



Indirect lighting with LED stripes in the skirting boards allow new design of the possibilities in the lighting engineering.

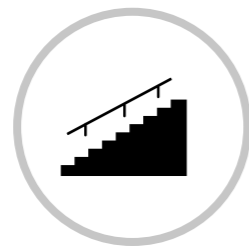

Also possible to use the skirting boards for steps, landings, stairs and curves. Simple but perfect.



- cut the profiles to size
- attach corner pieces
- mounting adhesive on rear side spread over the entire surface
- align with height
- fix
- before laying the floor covering remove protective film
- insert skirting board
- thats it!

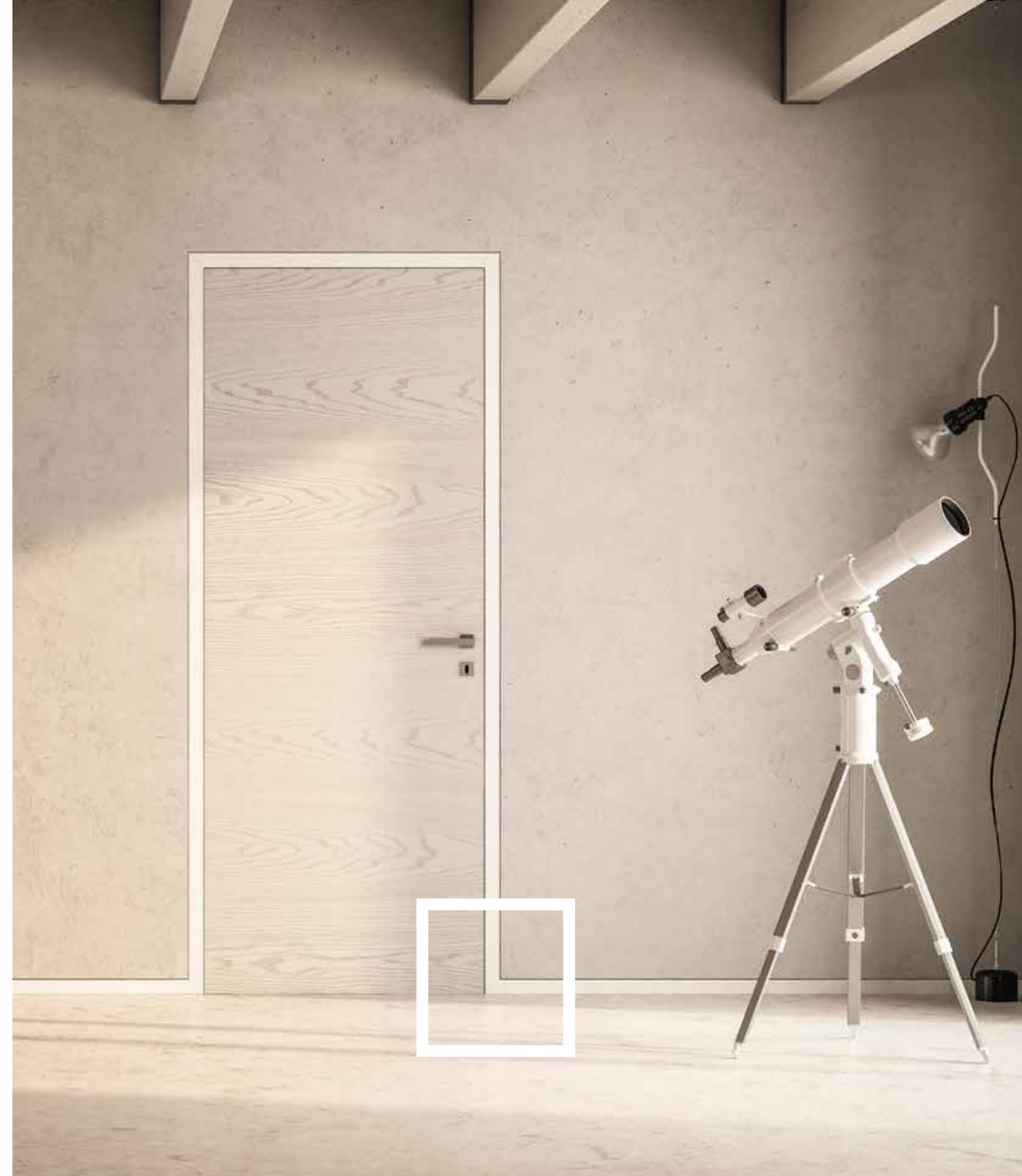

AGS-SYSTEMS

functionality and design

AGS-systems, the internationally operating Italian company, is the specialist for wall flush system solutions and stands for innovation, functionality and the realization of minimalist architecture.



ARCHITECTURE MEANS

the art of designing spaces while considering the harmonious interplay of all elements. The flush-mounted skirting board design shapes every room, radiates relaxation and elegance and enhances living quality.

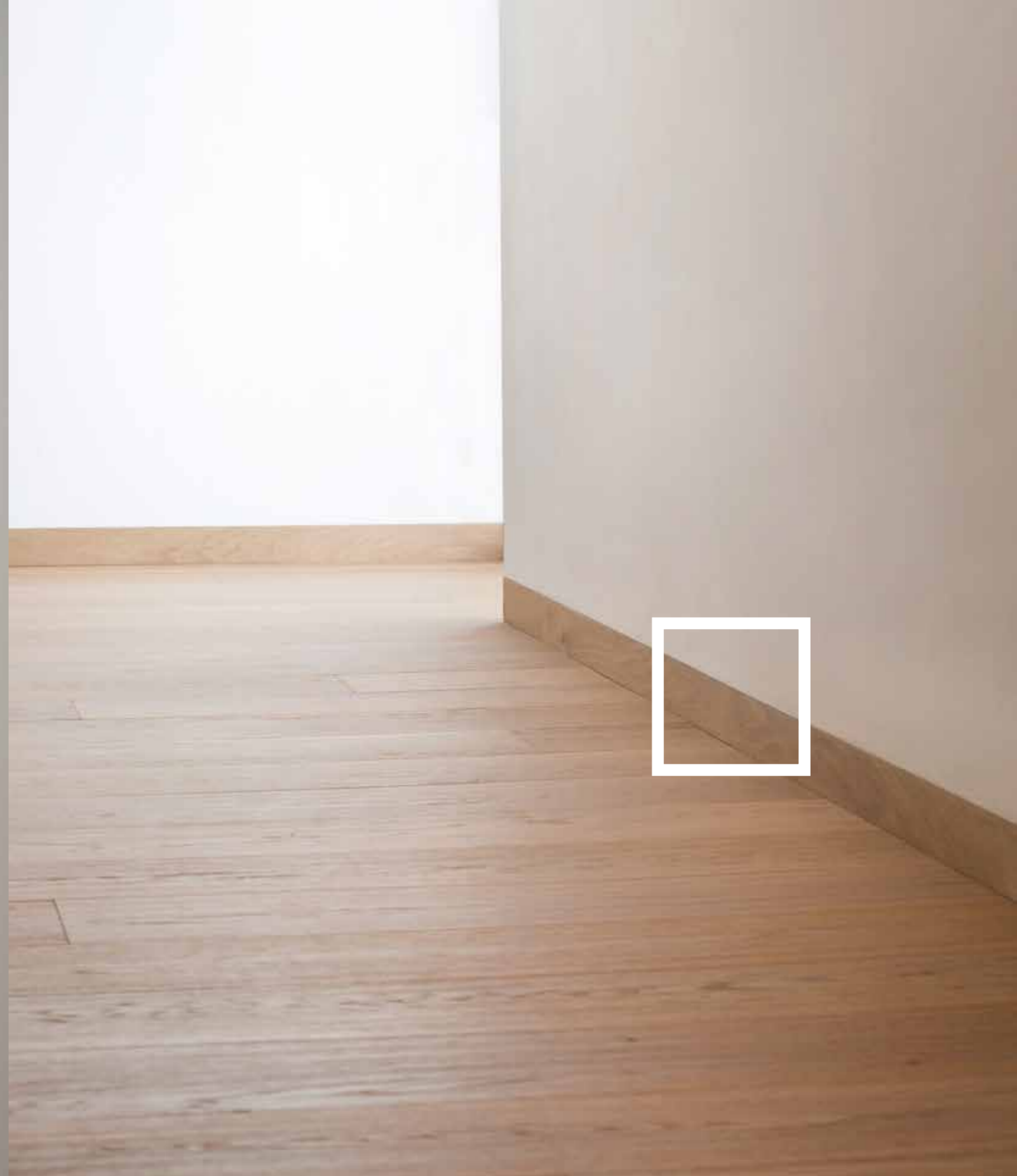

MINIMAL - AESTHETIC

Hygienic - Functional – Easy to assemble



HARMONIOUS PERFECTION

clear lines



HIGH LIVING COMFORT

for the discerning

MODEL LIGHT

aluminium profile for wooden skirting boards



product-features

- pre-drilled concealed profile in aluminium incl. protective foil
- profile length: 2,000 mm
- profile depth: 15 mm
- max. material depth: 9 mm

model

Light 46
profile height: 46 mm
art. 10046 for masonry
art. 10045 for drywall

Light 60
profile height: 60 mm
art. 10061 for masonry
art. 10060 for drywall

Light 80
profile height: 80 mm
art. 10080 for masonry

MODEL C70

aluminium profile for tiles/clinker/natural stones



product-features

- pre-drilled concealed profile in aluminium incl. protective foil
- profile length: 2,000 mm
- profile depth: 15 mm
- max. material depth: 12 mm

model

C70
profile height: 70 mm
art. 10171 for masonry
art. 10170 for drywall



MODEL S22

aluminium shadow gap profile



product-features

- for masonry and drywall
- incl. protective foil
- profile length: 2,000 mm
- profile height: 22+25 mm
- profile depth: 15 or 13.2 mm
- recess: 9.7 mm
- max. shadow gap height: 22 mm

model

S22
art. 10022 for masonry and drywall



MODEL S20

aluminium shadow gap profile
black anodized



product-features

- for masonry and drywall
- black anodized
- incl. protective foil
- profile length: 2,000 mm
- profile height: 20+17 mm
- profile depth: 14 or 13.5 mm
- recess: 11 mm
- max. shadow gap height: 20 mm

model

S20
art. 10020 for masonry and drywall



ACCESSORIES

internal corner

art. 11046 for Light46
art. 11060 for Light60/80
art. 11070 for C70

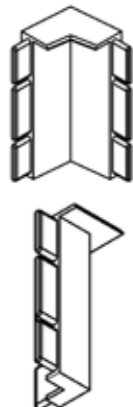

external corner

art. 12046 for Light46
art. 12060 for Light60/80
art. 12070 for C70

art. 50010 mounting foam free of CFC, PFC and HFC - green PU- Line

connecting strap

art. 13000 for Light46/60/80
art. 13002 for C70

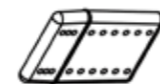

connecting strap variable

art. 13004 for Light46/60/80
art. 13005 for C70

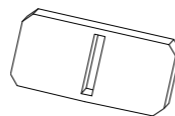

connecting strap for stairs

art. 13001 for Light46/60/80
art. 13003 for C70

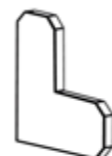

ACCESSORIES

connecting strap

art. 13000 for S22

connecting strap

art. 13002 for S20

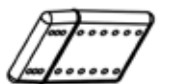

connecting strap variable

art. 13004 for S22

connecting strap variable

art. 13005 for S20

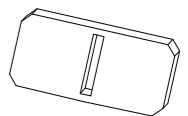

connecting strap for stairs

art. 13001 for S22

connecting strap for stairs

art. 13003 for S20

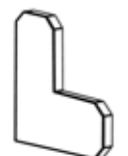

art. 50010 mounting foam free of CFC, PFC and HFC - green PU- Line

MODEL Z

concealed profile for drywall



product-features

- concealed profile with self-adhesive back
- profile length: 2,300 mm

model

art. 10090 - Z10
profile height: 61 mm
for gypsum plasterboard: 10 mm
max. material depth: 5.5 mm

art. 10091 - Z12
profile height: 58 mm
for gypsum plasterboard: 12.5 mm
max. material depth: 8 mm

art. 10092 - Z15
height: 56 mm
for gypsum plasterboard: 15 mm
max. material depth: 10.5 mm

art. 10093 - Z16
profile height: 55 mm
for gypsum plasterboard: 5/8"
max. material depth: 11.5 mm

aluminium cover powder-coated RAL9010
art. 40100/40101/40102/40103

aluminium cover powder-coated RAL9016
art. 40110/40111/40112/40113

aluminium cover anodized
art. 40120/40121/40122/40123

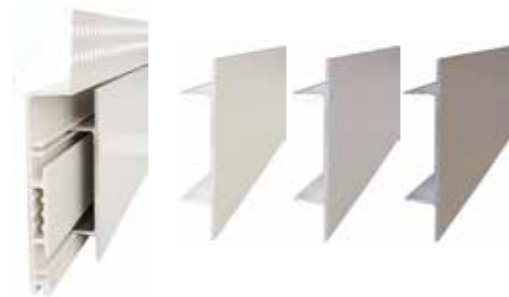

ACCESSORIES

connecting strap

art. 13002 for Z-profile

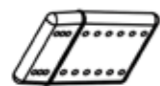

connecting strap for stairs

art. 13003 for Z-profile



connecting strap variable

art. 13005 for Z-profile

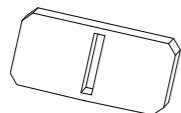

CONNECTING ELEMENTS

for wall flush skirting boards

Perfect transitions of lines are essential for design lovers. The sophisticated system with its specially manufactured connecting elements offers the possibility to connect wall flush skirting boards directly to the door frames in order to realize a seamless transition.

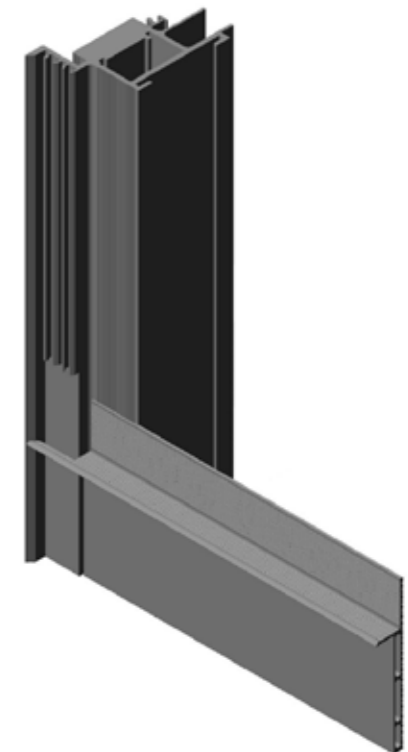

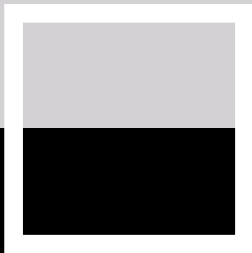

AGS-systems srl

Stava 47B – 39025 Naturno (BZ) Italy – tel. +39 0473 666376
info@ags-systems.com – www.ags-systems.info